

CTP-16 Base Plate: Mark Finish (x); Plate Size (x); Tie Length (x); Tie Finish (x)

1"(25mm)x2" (50mm)

16 gauge(1.5mm) Carbon Steel ASTM A 1008

- Hot Dipped Galvanized (H.D.G) per ASTM A153, C1, B2
- Stainless Steel (S.S) Type 304 per ASTM 167

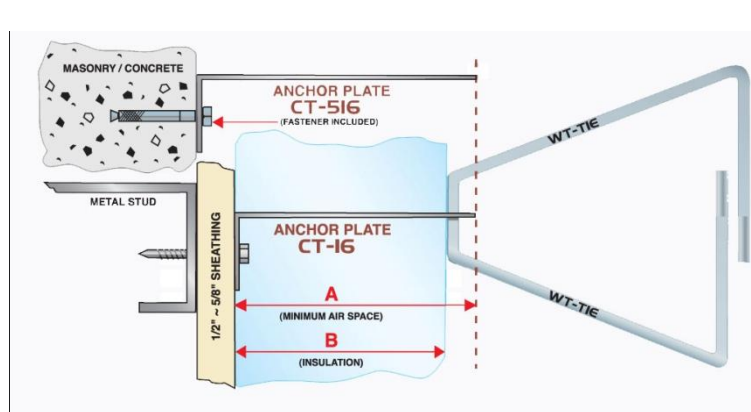
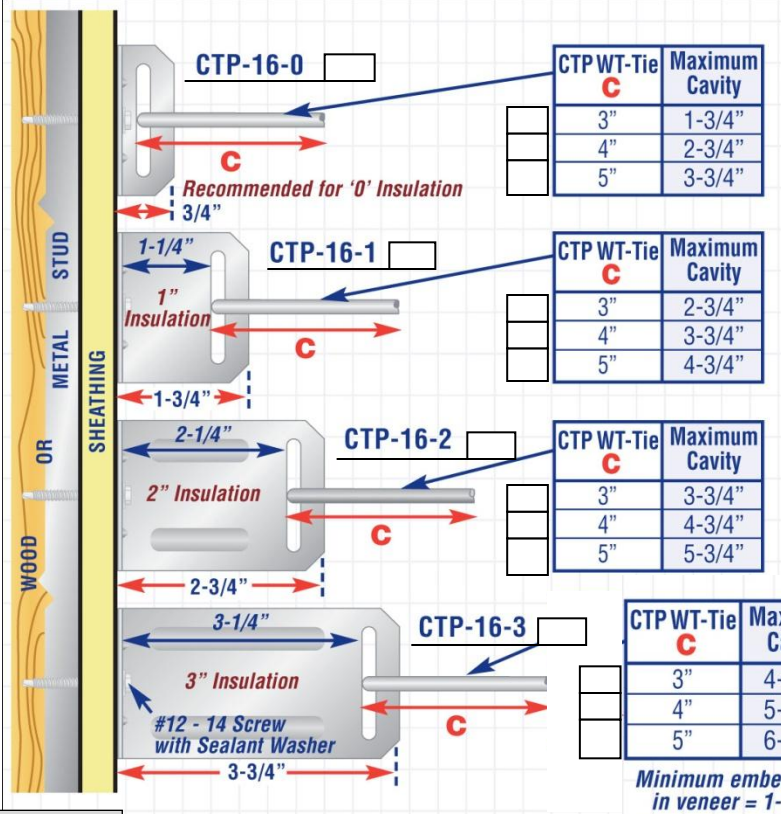

Wall Tie

The CTP WT-Tie is a multifunctional triangle wall tie that can be used in Standard or Seismic Anchoring Applications Finished in Hot Dip Galvanized Steel or Stainless Steel

The CTP WT-Tie is a Multifunctional Triangle Wall Tie

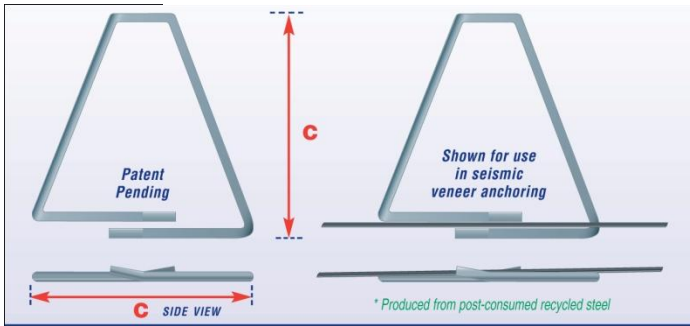

Material:

- 3/16" (4.76mm) Diameter Wire
- Carbon Steel per ASTM A 82
- Stainless Steel (S.S) Type 304 per ASTM A580

Finish:

- Hot Dipped Galvanized (H.D.G) per ASTM A153, C1, B2, 1.50 oz/f1² min.
- Stainless Steel – Clean and Dry

C	H.D.G.	S.S.
3"	CTP WT-32	CTP WT-35
4"	CTP WT-42	CTP WT-45
5"	CTP WT-52	CTP WT-55

Project: _____

Submitted By: _____

Date: _____

7974 W. Orchard Dr. * Michigan City, IN 46360 * Phone:(219)878-1427 * Fax: (219)874-3626

Email: steve@ctpanchors.com * www.ctpanchors.com